



Elevate Outswing French Door

Replacement Parts

Specifications and technical data are subject to change without notice.

Numbers listed in () parentheses are metric equivalents in millimeters rounded to the nearest whole number.

Suggested fasteners are not included and must be ordered separately.

Illustrations are not to scale.

Contents

Product History.....	2
Part Identification - Two Panel Operator XX.....	3
Part Identification - One Panel Operator X.....	4
Part Identification - Single Panel Stationary O.....	5
Installation Parts.....	6
Handles	7
Hinge Handing Location	14
Hinges.....	15
Hinges - Discontinued No Availability (NA).....	16
Locking Hardware	17
Fasteners.....	22
Aluminum Parts	26
Vinyl Parts.....	28
Wood Parts.....	29
Wood Parts - Discontinued No Availability (NA).....	31
Weather Strip.....	32
Weather Strip - Discontinued Limited Availability (LA).....	35
Panel Replacement	36

Produced	Unit Type	Features and Changes
2007	Outswing French Door	03/2007: Unit features 3/4" insulating Low E II tempered glass with Argon; mortise style multi-point locking system; keyed handle, 4 9/16" and 6 9/16" depths; adjustable hinges, solid wood interior, oak sill liner. The Elevate Outswing French Door is available in one panel (2665, 2668, 2680, 3065, 3068, 3080) stationary or operator and two panel (5065, 5068, 5080, 6065, 6068, 6080) jamb hinged configurations. Factory mulling is available (depending on configuration). Available in white, pebble, or bronze exterior colors; bare or white interior finishes. Handle sets available in White, Almond Frost, and Brass PVD, Satin Nickel PVD, or Oil Rubbed Bronze PVD finishes. Hinges available in White, Pebble Gray, Dark Brown, Coastal Satin Nickel, or Coastal Brass finishes. 11/2007: Evergreen exteriors introduced.
2008	Outswing French Door	03/17/2008: Cashmere exteriors introduced. 06/2008: Impact products introduced. 07/2008: Cottage SDL lite cut made available for Elevate. Refer to product bulletin #99.
2009	Outswing French Door	05/2009: LoE3 366 glass option introduced. Call number sizes 2-8 and 5-4 added. 08/2009: Header strike plate redesign.
2010	Outswing French Door	02/2010: Introduced new non handed hinge design.
2012	Outswing French Door	08/27/2012: Introduced Elevate Ebony exterior and exterior casing options.
2014	Outswing French Door	04/28/2014: Interior and Exterior Split Finish option became available so customers could choose different colors between exterior and interior handles. All current handle styles were given the name Cambridge. Handles are no longer available in sets. Introduced Special Size Door options. An addition of a CN 7-0 height option, available in 1/64" increments. 10/27/2014: Added Northfield hardware handle sets.
2017	Outswing French Door	06/26/2017: Introduced G2 ELOFD products. New hinge release and color offerings, Sill/Dark Weatherstrip release. 10/30/2017: Added availability to add locking handle to secondary panel. 12/18/2017: Added availability of customer specified divided lite cut configurations for SDL with and with out spacer bar and GBG. To include simulated check rail and allow any color GBG to the exterior only of standard and special sized units.
2018	Outswing French Door	10/29/2018: Introduced Designer Black and Clear interior finishes and Matte Black (MBK) hardware option. Replaced Sill Liner W2528 with V2935. All products will use the new PVC sill liner in place of the Oak. Low E3 ERS glass type was added. 12/17/2018: Introduced textured glass types: Obscure, Reed, Narrow Reed, Rain, Glue Chip and Frost and also colored glass types: Clear, Bronze, Gray and Green.
2019	Outswing French Door	12/16/2019: Discontinued the sale of Wood Removable Grilles.
2022	Outswing French Door	10/31/2022: Evergreen exterior discontinued. See Product Bulletin 851 for additional information.
2023	Outswing French Door	02/27/2023: Gunmetal introduced. See Product Bulletin 863 for additional information.

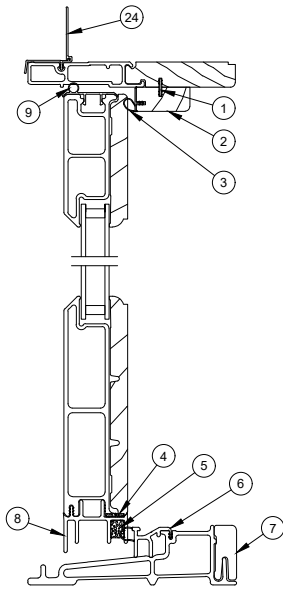

Head Jamb and Sill Detail

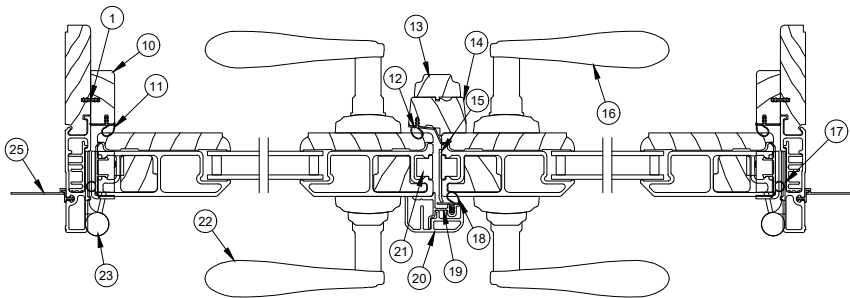

Jamb Detail

1. Head Jamb Connecting Barb
2. Panel Stop, Head Jamb, W9524
3. Head Jamb Weather Strip, V2793
4. Foam Tape
5. Foam
6. Sill Weather Strip, V2816
7. Sill Liner, V2935
8. Sweep, Operator Panel, V1547/V2821
9. Panel Top Rail Weather Strip, V1550
10. Panel Stop, Jamb, W9524
11. Jamb Weather Strip, V2793
12. Interior Astragal Weather Strip, V1560
13. Interior Astragal Cover, W7554
14. Interior Astragal Base, W9609
15. Mortise Lock
16. Interior Handle
17. Stile Panel Weather Strip, V1550
18. Exterior Astragal Weather Strip, V2800
19. Astragal Base, Exterior, A1432
20. Astragal Cap, Exterior, A1431
21. Mortise Lock
22. Exterior Handle
23. Adjustable Hinge
24. Head Jamb Nailing Fin/Drip Cap, V119
25. Jamb Nailing Fin, V104

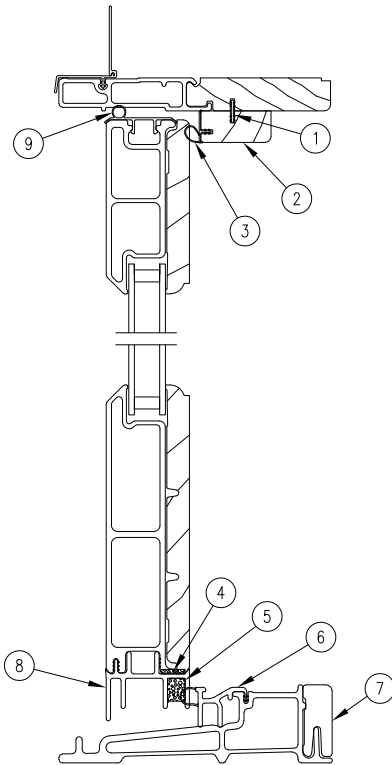

Head Jamb and Sill Detail

1. Connecting Barb
2. Panel Stop, Jamb, W9524
3. Frame Weather Strip, Head Jamb, V2793
4. Foam Tape
5. Foam
6. Sill Weather Strip, V2816
7. Sill Liner, V2935
8. Sweep, Operator Panel, V1547/V2821
9. Panel Top Rail Weather Strip, V1550
10. Panel Stile Weather Strip, V1550
11. Panel Stop, Jamb, W9524
12. Frame Weather Strip, Jamb, V2793
13. Interior Handle
14. Strike Plate
15. Panel Locking Stile Weather Strip, V1556
16. Exterior Handle
17. Adjustable Hinge

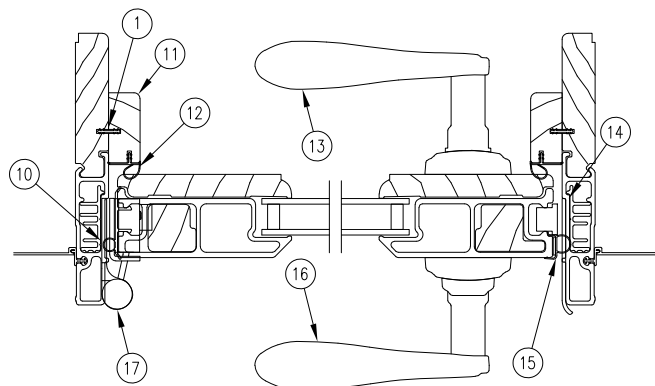

Jamb Detail

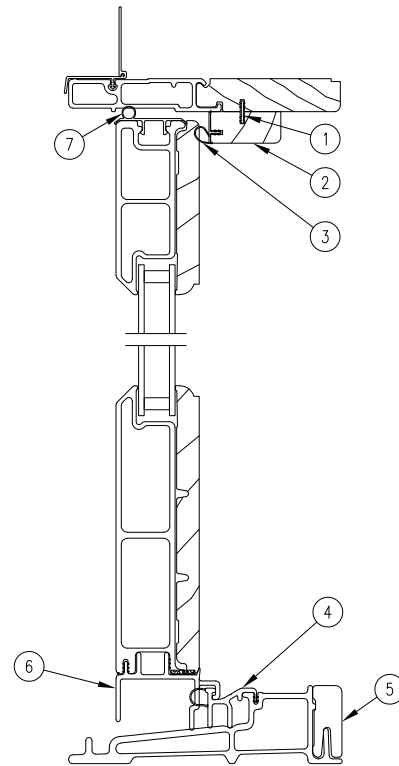

Head Jamb and Sill Detail

1. Connecting Barb
2. Panel Stop, Head Jamb, W9524
3. Frame Weather Strip, Head Jamb, V2793
4. Sill Weather Strip, V2816
5. Sill Liner, V2935
6. Sweep, Stationary Panel, V1551
7. Panel Top Rail Weather Strip, V1550
8. Stationary Panel Clip
9. Panel Stop, Jamb, W9524
10. Frame Weather Strip, Jamb, V2793
11. Stationary Jamb Block, W8679
12. Panel Locking Stile Weather Strip, V1556

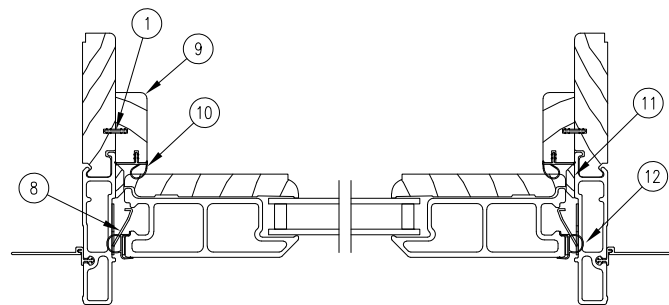

Jamb Detail

Installation Kit

Includes:

- 2 - 3/16" flat head masonry screw (a)
- 1 - #8 x 2 1/2" flat head Stainless Steel screw (b)
- 1 - #8 x 2 1/2" flat head brass screw (b)
- 2 - #8 x 2 1/2" flat head beige screws (b)
- 2 - Jamb hole plug, beige - 111018 (c)
- 2 - Jamb hole plug, ebony - 111023 (c)
- 1 - Set of installation instructions

PN
11896597

Impact Nailing Fin Installation Kit

Includes:

- 2 - 3/16" x 2 3/4" flat head masonry screw (a)
- 1 - #8 x 2 1/2" flat head Stainless Steel screw (b)
- 1 - #8 x 2 1/2" flat head brass screw (b)
- 2 - #8 x 2 1/2" flat head beige screws (b)
- 2 - Jamb hole plug, beige - 111018 (c)
- 2 - Jamb hole plug, ebony - 111023 (c)
- 17 - Installation clip (d)
- 51 - Installation clip screws - 11800758
- 1 - Set of installation instructions
- 1 - Supplemental installation instruction

PN
11896808

Impact Nailing Fin Installation Kit

Includes:

- Installation clip (d)
- #7 x 5/8" Installation clip screws (11800758)

Qty of Clips	Qty of Screws	PN
1	3	11896810
20	60	11896809

Jamb Hole Plug

NOTE: Used at jamb and sill liner

Color	PN
Beige	111018
Ebony	111023

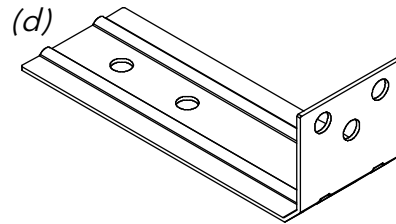
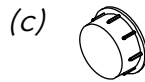
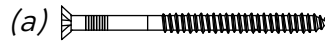
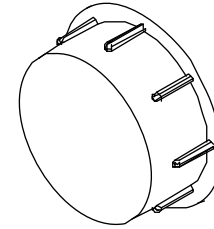

Cambridge Primary Handle Set, Exterior

Includes:

- 1 - Exterior handle
- 1 - Exterior escutcheon
- 1 - Hardware gasket
- 1 - Z Clip
- 1 - Z Clip screw
- 1 - Keyed cylinder

Usage dates:

06/26/2017 to present

NOTE: Escutcheon width 1.350"

Color	XX-R, X-R	XX-L, X-L
Almond Frost	11868026	11868021
Stone White	11868031	11868019
Brass PVD	11868028	11868023
Satin Nickel PVD	11868029	11868024
Oil Rubbed Bronze PVD	11868030	11868025
Matte Black	11868069	11868068

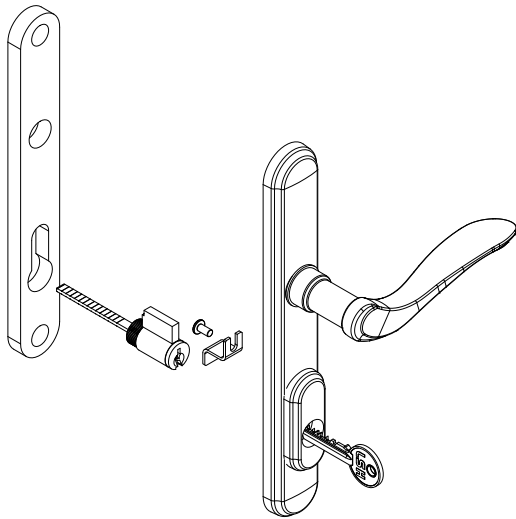

XX-L X-L shown

Cambridge Primary Handle Set, Interior

Includes:

- 1 - Interior handle
- 1 - Interior escutcheon
- 1 - Spring cassette
- 1 - Spindle
- 1 - Thumb turn
- 2 - M5 x 58 machine screws

Color	XX-R, X-R	XX-L, X-L
Almond Frost	11869106	11869101
Stone White	11869210	11869209
Brass PVD	11869108	11869103
Satin Nickel PVD	11869109	11869104
Oil Rubbed Bronze PVD	11869110	11869105
Matte Black	11869149	11869169

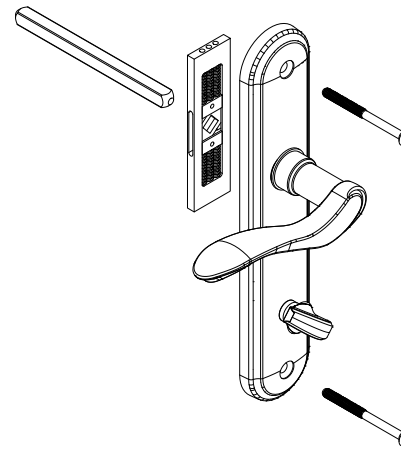

XX-L, X-L shown

Cambridge Secondary Handle Set, Exterior

Includes:

- 1 - Exterior handle
- 1 - Exterior escutcheon
- 1 - Hardware gasket

Usage dates:

06/26/2017 to present

NOTE: Escutcheon width 1.350"

Color	XX-L	XX-R
Almond Frost	11868046	11868041
Stone White	11868037	11868032
Brass PVD	11868048	11868043
Satin Nickel PVD	11868049	11868044
Oil Rubbed Bronze PVD	11868050	11868045
Matte Black	11868071	11868070

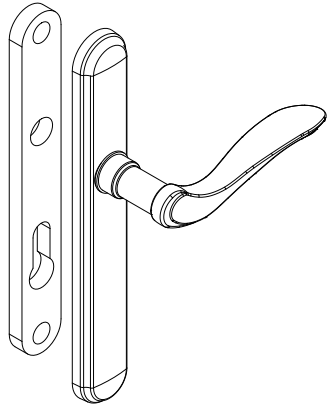

XX-L shown

Cambridge Secondary Handle Set, Interior

Includes:

- 1 - Interior handle
- 1 - Interior escutcheon
- 1 - Spring cassette
- 1 - Spindle
- 2 - M5 x 58 machine screws

Color	XX-L	XX-R
Almond Frost	11869126	11869121
Stone White	11869227	11869222
Brass PVD	11869128	11869123
Satin Nickel PVD	11869129	11869124
Oil Rubbed Bronze PVD	11869130	11869125
Matte Black	11869159	11869150

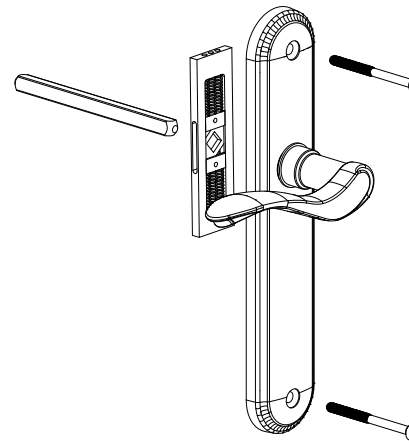

XX-R shown

Northfield Primary Handle Set, Exterior

Includes:

- 1 - Exterior handle
- 1 - Exterior escutcheon
- 1 - Hardware gasket
- 1 - Z Clip
- 1 - Z Clip screw
- 1 - Keyed cylinder

Usage dates:

10/2014 to present

Color	PN
Almond Frost	11869161
Stone White	11869162
Brass PVD	11869163
Satin Nickel PVD	11869164
Oil Rubbed Bronze PVD	11869165
Matte Black	11869168

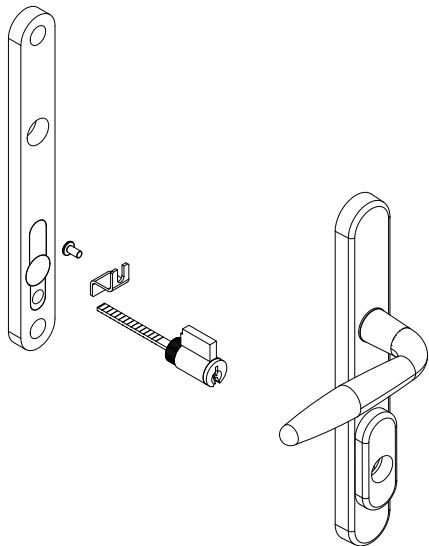

Northfield Primary Handle Set, Interior

Includes:

- 1 - Interior handle
- 1 - Interior escutcheon
- 1 - Spring cassette
- 1 - Spindle
- 1 - Thumb turn
- 2 - M5 x 58 machine screws

Usage dates:

10/2014 to present

Color	PN
Almond Frost	11869151
Stone White	11869152
Brass PVD	11869153
Satin Nickel PVD	11869154
Oil Rubbed Bronze PVD	11869155
Matte Black	11869160

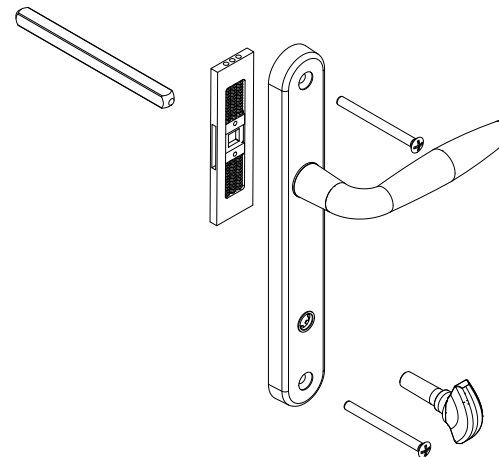

Northfield Secondary Handle Set, Exterior

Includes:

- 1 - Exterior handle
- 1 - Exterior escutcheon
- 1 - Handle gasket

Usage dates:

10/2014 to present

Color	PN
Almond Frost	11869181
Stone White	11869182
Brass PVD	11869183
Satin Nickel PVD	11869184
Oil Rubbed Bronze PVD	11869185
Matte Black	11869190

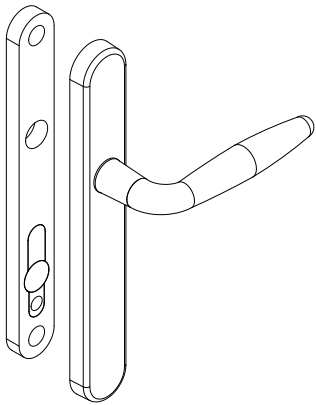

Northfield Secondary Handle Set, Interior

Includes:

- 1 - Interior handle
- 1 - Interior escutcheon
- 1 - Spring cassette
- 1 - Spindle
- 2 - M5 x 58 machine screws

Usage dates:

10/2014 to present

Color	PN
Almond Frost	11869171
Stone White	11869172
Brass PVD	11869173
Satin Nickel PVD	11869174
Oil Rubbed Bronze PVD	11869175
Matte Black	11869180

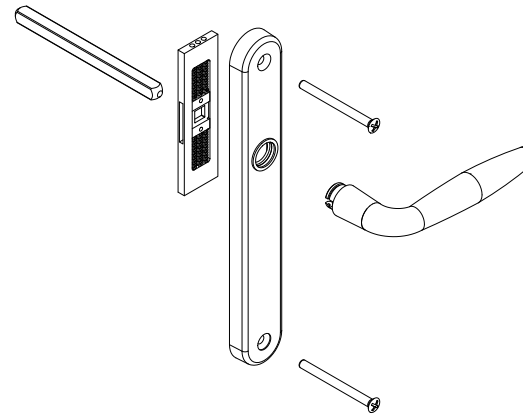

Hardware Gasket

PN
11860969

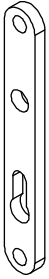

Spring Cassette

PN
11860960

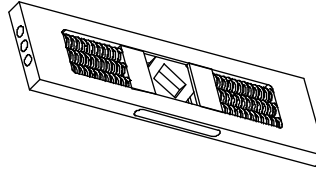

Escutcheon Plate Screws

NOTE: 1-M5 x 58 machine screw

Color	PN
Brass PVD	11805189
White	11805188
Almond Frost	11805187
Satin Nickel PVD	11805190
Oil Rubbed Bronze PVD	11805191
Matte Black	11805143

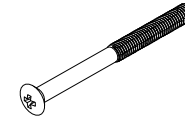

Z-Clip

Includes:

2 - Fasteners

NOTE: Used on both Cambridge and Northfield hardware

PN
11860967

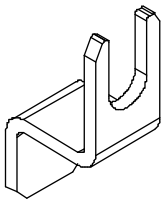

Replacement Washers

PN
11860964

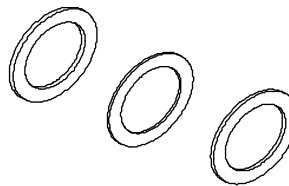

Split Ring

PN
11860966

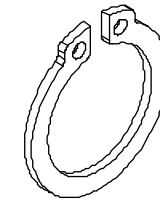

Secondary Panel Lock Handle Template

NOTE: Handle retro-fit instructions (19915821) not included.

NOTE: Not to scale.

PN
10503000



Keyed Cylinder with Keys

NOTE: Schlage cylinder

NOTE: For keyed alike cylinders, please contact your Marvin representative. Please supply the original order number if possible.

Color	PN
Brass	11860963

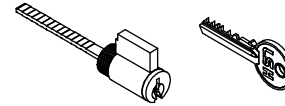

Clip, Thumb Turn

PN
11860972

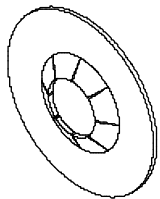

Spindle

PN
11860962

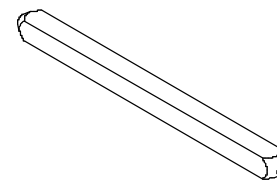

Cambridge Primary Handle Set, Exterior

Includes:

- 1 - Exterior Handle
- 1 - Exterior Escutcheon
- 1 - Hardware Gasket
- 1 - Z Clip
- 1 - Z Clip Screw
- 1 - Keyed Cylinder

Usage dates:

03/2007 to 06/26/2017

NOTE: Escutcheon width 1.796"

Color	XX-R X-R, PN	XX-L, X-L, PN
Almond Frost	11869116	11869111
White	11869117	11869112
Brass PVD	11869118	11869113
Satin Nickel PVD	11869119	11869114
Oil Rubbed Bronze PVD	11869156	11869115

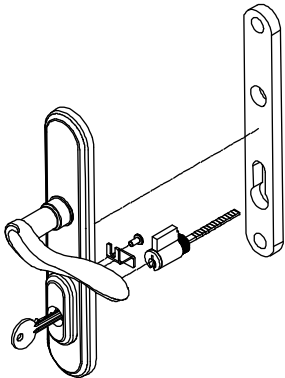

XX-L, X-L shown

Cambridge Secondary Handle Set, Exterior

Includes:

- 1 - Exterior Handle
- 1 - Exterior Escutcheon
- 1 - Hardware Gasket

Usage dates:

03/2007 to 06/26/2017

NOTE: Escutcheon width 1.796"

Color	XX-R	XX-L
Almond Frost	11869131	11869136
White	11869132	11869137
Brass PVD	11869133	11869138
Satin Nickel PVD	11869134	11869139
Oil Rubbed Bronze PVD	11869135	11869140

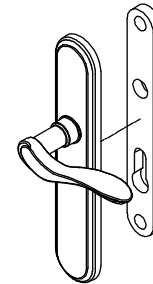

XX-L shown

**NOTE: Always view units
from the exterior for handing.
H=Hinge location**

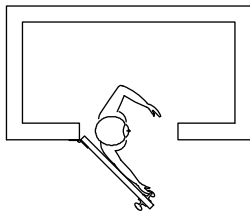

RH Outswing

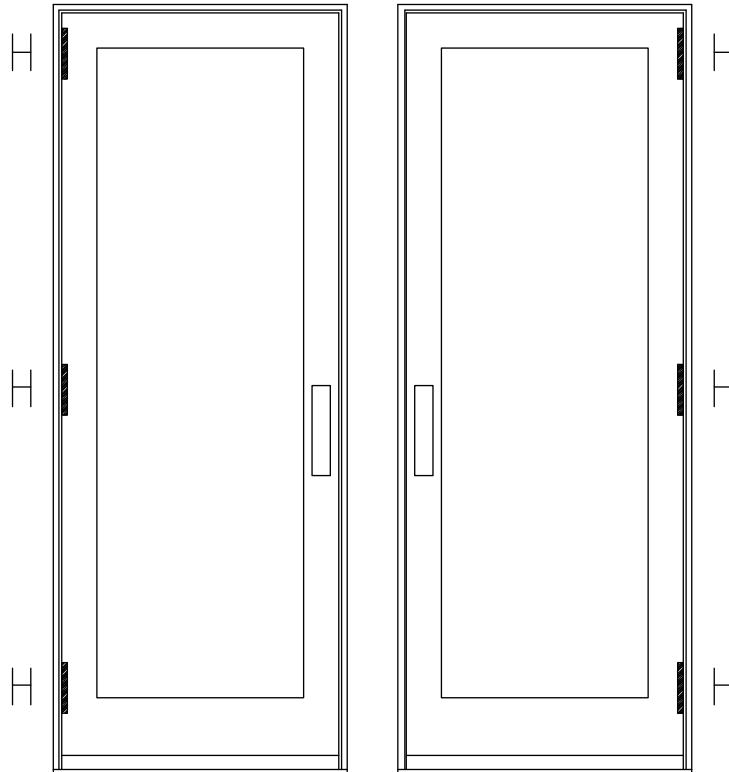

X-RH Outswing
This panel uses the
right hand hinge

X-LH Outswing
This panel uses the
left hand hinge

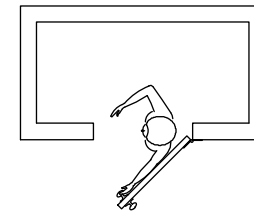

LH Outswing

Adjustable Hinge

Includes:

- 1 - Hinge gasket
- 3 - #8 x 5/8" Phillips flat head screw (into jamb)
- 8 - #8 x 1 1/2" Phillips flat head screw (into panel)
- 2 - #8 x 2 1/2" Phillips flat head screw (installation into jamb)
- 1 - Hinge retro-fit instructions

NOTE: All screws are color matched

NOTE: For units produced before 06/26/2017: 3 hinge kits for frame height <= to 82.000", 4 hinge kits for frame height > than 82.000".

Color	X-R, XX-R	X-L, XX-L
Goldtone	11891400	11891401
Gray	11891402	11891403
Almond Frost	11891408	11891409
Cashmere	11891420	11891421
Pebble	11891418	11891419
Dark Brown	11891404	11891405
White	11891406	11891407
Ebony	11891422	11891423
Brass PVD	11891410	11891411
Satin Nickel PVD	11891412	11891413
Oil Rubbed Bronze PVD	11891414	11891415
*Evergreen	11891416	11891417

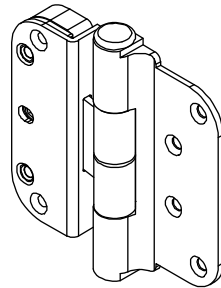

RH shown

NOTE: *DISC (LA) used prior to 10/29/2022

Hinge Spacer Block

Usage dates:

03/2004 to present

Color	PN
Stone White	11860167
Pebble	11860166
Bronze	11860165
Cashmere	11860183
Ebony	11860184
*Evergreen	11860179

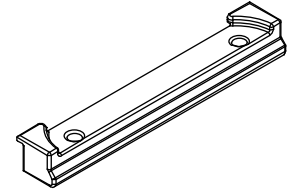

NOTE: *DISC (LA) used prior to 10/29/2022

Hinge Replacement Guide

NOTE: Hinge retro-fit instructions are not included (19915714)

PN
10500419

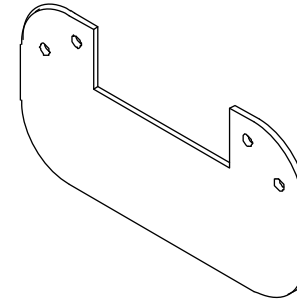

Hinge Adjustment Tool

PN
10502561

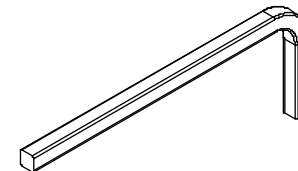

NOTE: Replace with adjustable hinge, L/R. Please specify total hinge quantity on unit when placing Field Service order

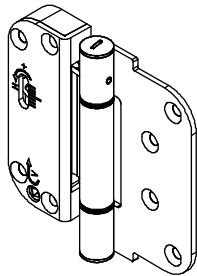

Non Handed Hinge

Usage: 02/22/2010 to
06/26/2017

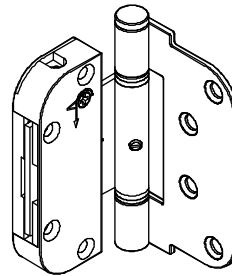

Set Hinge

Usage: 03/2007 to
02/21/2010

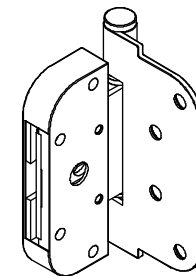

Guide Hinge

Usage: 03/2007 to
02/21/2010

Active Multi-Point

Includes:

- 1 - Lock assembly with faceplate, deadbolt, latch and shoot bolts
- 11 (13 on 8/0) - #8 x 1 1/2" Phillips flat head Stainless Steel screws

CN	Color	PN
6-5	Stainless Steel	11896553
6-8		11896554
7-0		11896670
8-0		11896555

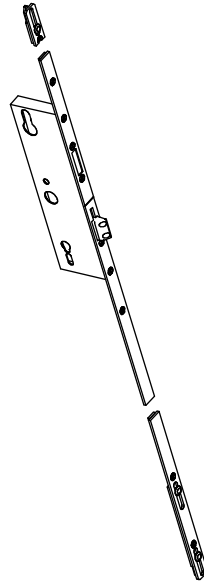

Special Size Active Multi-Point

Includes:

- 1 - Lock assembly with faceplate, deadbolt, latch and lower shoot bolts
- 1 - Top shoot bolt extension
- 12 - #8 x 1 1/2" Phillips flat head Stainless Steel screws

Color	PN
Stainless Steel	11896669

Inactive Multi-Point

Includes:

- 1 - Lock assembly with faceplate and shoot bolts
- 11 (13 on 8/0) - #8 x 1 1/2" Phillips flat head Stainless Steel screws

CN	Color	PN
6-5	Stainless Steel	11896556
6-8		11896557
7-0		11897770
8-0		11896558

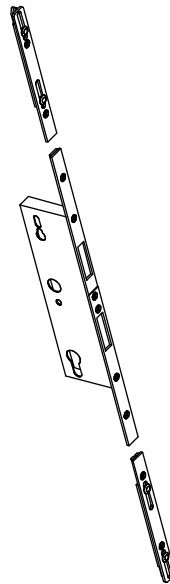

Special Size Inactive Multi-Point

Includes:

- 1 - Lock assembly with faceplate and lower shoot bolts
- 1 - Top shoot bolt extension
- 12 - #8 x 1 1/2" Phillips flat head Stainless Steel screws

Color	PN
Stainless Steel	11897769

Multi-Point Lockbox, Active

PN
11896707

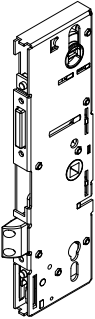

Multi-Point Lockbox, Passive

PN
11896708

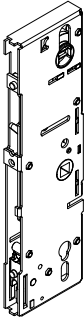

Strike Plate, Locking Jamb

Includes:

- 1 - Jamb strike plate
- 2 - #8 x 5/8" Phillips flat head screws (Stainless Steel 11805180, Brass 11800580)
- 1 - #8 x 2 1/2" Phillips flat head screws (Stainless Steel 11800648, Brass 11805165)

Configuration	Color	PN
X-R	Stainless Steel	11896674
	Brass	11896676
X-L	Stainless Steel	11896675
	Brass	11896677

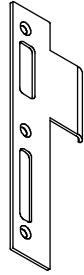

X-R shown

Strike Plate, Secondary Lock

Configuration	Color	PN
XX-R	Stainless Steel	11896560
	Brass	11860187
XX-L	Stainless Steel	11896559
	Brass	11860186

Suggested Fasteners	Color	PN
1 - 4mm x 16mm Torx flat head machine screw	Stainless Steel	11805183
1 - 4mm x 8mm Torx flat head machine screw	Stainless Steel	11805181
1 - 4mm x 35mm Torx flat head machine screw	Stainless Steel	11805184



XX-R shown

Head Jamb Strike, XX

Includes:

- 1 - Strike
- 2 - #8 x 5/8" Phillips flat head screws (Stainless Steel 11805180)
- 2 - #8 x 2 1/2" Phillips flat head screws (Stainless Steel 11800648)

Usage dates:

08/31/2009 to present

Color	PN
Stainless Steel	11897011

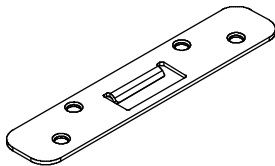

Head Jamb Strike - X, Standard and Impact

Includes:

- 1 - Strike
- 2 - #8 x 5/8" Phillips flat head screws (11805180)

Usage dates:

08/31/2009 to present

Color	LH PN	RH PN
Stainless Steel	11897009	11897007

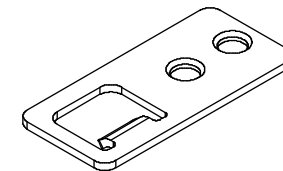

Sill Strike Plate - XX

Includes:

- 1 - Strike plate
- 2 - #8-15 x 3/4" Phillips flat head screws (11805321)

Color	PN
Stainless Steel	11896551

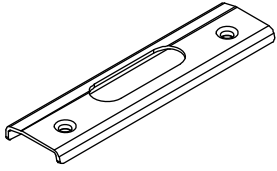

Sill Strike - XX

Includes:

- 1 - Strike
- 2 - #8-15 x 3/4" Phillips flat head screws (11805321)

Color	PN
Black	11896512
Beige	11896550

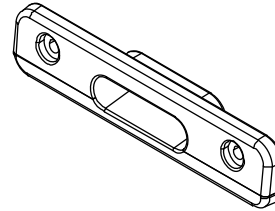

Sill Strike - X

Includes:

- 1 - Strike
- 1 - #8 x 5/8" Phillips truss head vinyl screw (Black 11805139, Beige 11805192)

Color	PN
Black	11896511
Beige	11896678

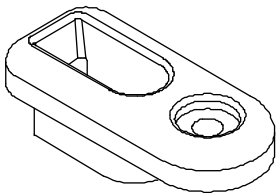

Bottom Shoot Bolt Guide

Includes:

- 1 - Guide
- 1 - #8 x 2 1/2" Phillips truss head screw (11805151)
- 1 - #8 x 1 1/4" Phillips truss head screw (11805193)

LH PN	RH PN
11896566	11896565

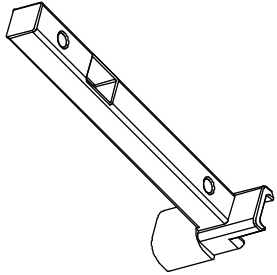

Top Shoot Bolt Guide

Includes:

- 1 - Guide
- 1 - #8 x 1" Phillips pan head screw (11805185)

LH PN	RH PN
11896564	11896563

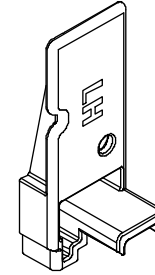

Bolt Plug, Locking Jamb

Color	PN
Black	11862552

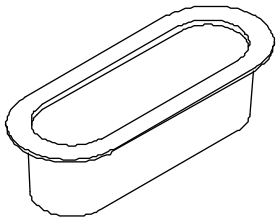

Latch Plug, Locking Jamb

Color	PN
Black	11862553

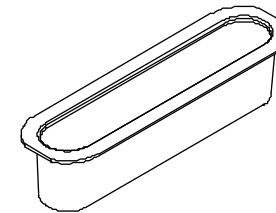

Stationary Panel Clip

Includes:

- 1 - Stationary panel clip
- 2 - Rivets (11800113)

Color	PN
Black	11896680

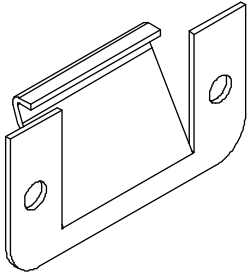

Stationary Panel Bracket

Includes:

- 1 - Bracket
- 2 - #8 x 1" Phillips truss head screws (panel) (11800867)
- 2 - #8 x 1/2" Phillips flat head screws (frame) (11800502)

Color	PN
Stainless Steel	11896683

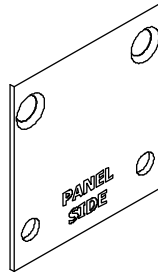

Through Jamb Plug

Color	PN
Beige	11882968
Black	11882168
Stone White	11882868

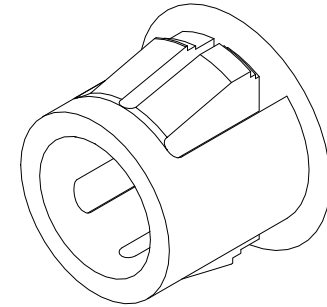

#8 x 5/8" Phillips Flat Head Screw

Usage:

Head jamb strike to head jamb

Hinges to jamb

Locking jamb strike plate to jamb

NOTE: Dark Brown fasteners should be used for ebony hinges

Color	PN EA
Stainless Steel	11805169
Beige	11805170
Brass	11805171
Stone White	11800850
Dark Brown	11800496
Pebble	11800494
Cashmere	11805146
*Evergreen	11806148

NOTE: *DISC (LA) used prior to 10/29/2022

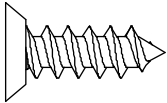

#8 x 1/2" Phillips Flat Head Screw

Usage:

Through stationary panel bracket into jamb

Color	PN
Zinc	11800502



#8 x 5/8" " Pan Head Screw, Self-drilling/Tapping

Usage:

Through exterior astragal base into panel

Through astragal base into astragal cap

Color	PN
Stainless Steel	11800498

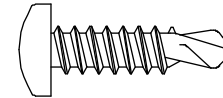

#8 x 5/8" Phillips Truss Head Screw, Blunt

Usage:

Through X sill strike

Color	PN
Beige	11805192
Black	11805139

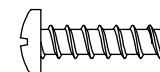

#8 x 1" Phillips Pan Head Screw

Usage:

Through top and bottom shoot bolt guides

Color	PN
Stainless Steel	11805185

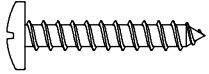

#8 x 1" Phillips Truss Head Screw

Usage:

Through stationary panel brackets into panel

Color	PN
ZYD	11800867

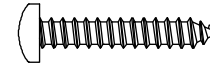

#8-15 x 3/4" Phillips Type A-17 Full Thread Screw

Usage:

Through XX sill strike

Color	PN
ZYD	11805321

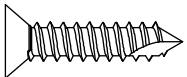

#8 x 1 1/4" Phillips Truss Head Screw

Usage:

Through sweep into panel

Color	PN
Stainless Steel	11805193

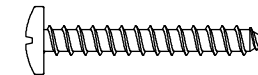

#8 x 1 1/4" Phillips Flat Head 2/3 Thread Screw

Usage:

Astragal cap to astragal base

Color	PN
ZYD	11805179

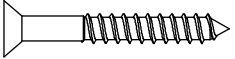

#8 x 1 1/2" Phillips Flat Head Screw

Usage:

Hinge to panel

Multi-point lock to panel (Stainless Steel only)

NOTE: Dark Brown fasteners should be used for ebony hinges

Color	PN
Brass	11805171
White	11805169
Dark Brown	11805170
Pebble	11805174
Stainless Steel	11805173
Cashmere	11805182
*Evergreen	11805177

NOTE: *DISC (LA) used prior to 10/29/2022

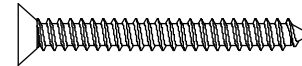

#8 x 2" Phillips Flat Head Screw

Usage:

Through astragal base into panel

Color	PN
ZYD	11800868

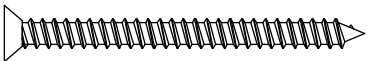

#8 x 2 1/2" Phillips Truss Head Screw

Usage:

Through sweep into panel

Through bottom shoot bolt guide into panel

Color	PN
Stainless Steel	11805151



#8 x 5/8" Phillips Flat Head Screw

Usage:

Hinge

NOTE: Dark Brown fasteners should be used for ebony and bronze replacement needs

Color	Pkg of 25 PN
White	11882723
Dark Brown	11882724
Brass	11882725
Satin Nickel	11882726
Pebble	11882727
Cashmere	11882729
*Evergreen	11882728



NOTE: *DISC (LA) used prior to 10/29/2022

#8 x 1 1/2" Phillips Flat Head Screw

Usage:

Hinge

NOTE: Dark Brown fasteners should be used for ebony and bronze replacement needs

Color	Pkg of 25 PN
White	11882713
Dark Brown	11882714
Brass	11882715
Satin Nickel	11882716
Pebble	11882717
Cashmere	11882719
*Evergreen	11882718

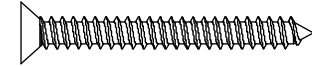

NOTE: *DISC (LA) used prior to 10/29/2022

#8 x 2 1/2" Phillips Flat Head Screw

Usage:

Hinge

NOTE: Dark Brown fasteners should be used for ebony and bronze replacement needs

Color	Pkg of 25 PN
White	11882703
Dark Brown	11882704
Brass	11882705
Satin Nickel	11882706
Pebble	11882707
Cashmere	11882709
*Evergreen	11882708

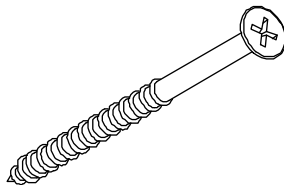

NOTE: *DISC (LA) used prior to 10/29/2022

Astragal Cap - Exterior

A1431

Includes:

- 1 - Astragal base
- 9 - #8 x 5/8" Phillips pan head screws

CN Height	Length	Color and Part Number						
		Stone White	Pebble	Bronze	Cashmere	Ebony	Gunmetal	*Evergreen
6-5	77 23/32" (1974)	11896570	11896573	11896687	11896956	11897477	19885765	11896953
6-8	80 7/32" (2038)	11896571	11896574	11896688	11896957	11897478	19885768	11896954
7-0	84 7/32" (2139)	11892470	11893470	11894470	11897470	11897479	19855770	11895470
8-0	93 23/32" (2380)	11896572	11896575	11896689	11896958	11897480	19885780	11896955

NOTE: *DISC (LA) used prior to 10/29/2022

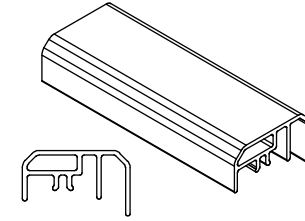

Astragal Cap - Impact, Exterior

A1464

Includes:

- 1 - Astragal base
- 8 - #8 x 5/8" Phillips pan head screws

CN Height	Length	Color and Part Number						
		Stone White	Pebble	Bronze	Cashmere	Ebony	Gunmetal	*Evergreen
6-5	77 23/32" (1974)	19455466	19455566	19455666	19455866	11897081	19855766	19455766
6-8	80 7/32" (2038)	19455469	19455569	19455669	19455869	11897082	19855769	19455769
7-0	84 7/32" (2139)	11897671	11897672	11897673	11897675	11897083	19855771	11897674
8-0	93 23/32" (2380)	19455481	19455581	19455681	19455881	11897084	19855781	19455781

NOTE: *DISC (LA) used prior to 10/29/2022

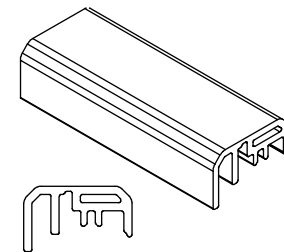

Astragal Base - Exterior

A1432

Includes:

- 1 - Astragal base
- 9 - #8 x 5/8" Phillips pan head screws

CN	Length	PN
6-5	75 7/16" (1916)	11896567
6-8	77 15/16" (1980)	11896568
7-0	81 15/16" (2081)	11897570
8-0	91 7/16" (2323)	11896569

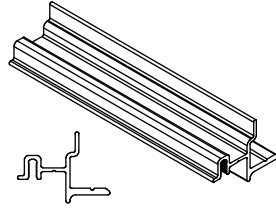

Sweep - Operator Panel

V1547/V2821

Includes:

- 1 - Sweep
- 2 - #8 x 2 1/2" Phillips truss head screws

CN Width	Length	Beige PN	Black PN
2-6/5-0	28 19/32" (726)	11896561	11897526
2-8/5-4	30 19/32" (777)	11896952	11897528
3-0/6-0	34 19/32" (879)	11896562	11897530

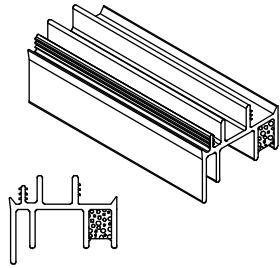

Sweep - Stationary Panel

V1551

Includes:

- 1 - Sweep
- 2 - #8 x 2 1/2" Phillips truss head screws

CN Width	Length	Beige PN	Black PN
2-6/5-0	28 19/32" (726)	11896681	11896826
2-8/5-4	30 19/32" (777)	11896951	11896828
3-0/6-0	34 19/32" (879)	11896682	11896830

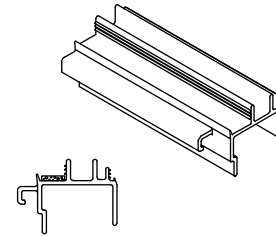

Sill Liner

V2935

Usage:

10/29/2018 to present

CN Width	Length	Beige PN	Black PN
2-6	30 3/16" (767)	11110026	15960026
2-8	32 3/16" (818)	11110028	15960028
3-0	36 3/16" (919)	11110030	15960030
5-0	58 7/8" (1495)	11110050	15960050
5-4	62 7/8" (1597)	11110054	15960054
6-0	70 7/8" (1800)	11110060	15960060

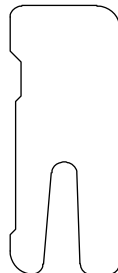

Panel Stop

W9524

Includes:

Panel Stop
 Connecting barb, V803
 Frame weather strip, V2793

NOTE: All replacement parts will have black weather strip.

Head Jamb					
CN width	Length	Finish and Part Number			
		Bare Wood	White	Designer Black	Clear
2-6	28 15/16" (735)	11906630	11906672	11890630	11886930
2-8	30 15/16" (786)	11906690	11906692	11890690	11886990
3-0	34 15/16" (913)	11906671	11906673	11890671	11886931
5-0	57 5/8" (1464)	11906546	11906548	11890646	11886946
5-4	61 5/8" (1565)	11906691	11906693	11890691	11886991
6-0	69 5/8" (1768)	11906547	11906549	11890647	11886961

Jamb					
CN height	Length	Finish and Part Number			
		Bare Wood	White	Designer Black	Clear
6-5	76 15/32" (1842)	11906540	11906543	11896240	11886940
6-8	78 31/32" (2006)	11906541	11906544	11896241	11886969
7-0	82 31/32" (2107)	11906470	11906471	11896270	11886970
8-0	92 15/32" (2425)	11906542	11906545	11896242	11886942

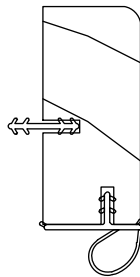

Stationary Jamb Block

W8679

Length	Finish and Part Number	
	Bare Wood	White Interior
6" (152)	31500020	N/A



Interior Astragal Cover, 6-8 and under

W7554

CN height	Length	Finish and Part Number			
		Bare Wood	White	Designer Black	Clear
6-5	76 3/32" (1933)	31506265	39206265	39209265	31606268
6-8	78 19/32" (1996)	31506268	39206268	39209268	31606258

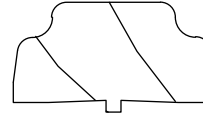

Suggested Fasteners	PN
2 - #8 x 1 1/4" Phillips flat head screws	11805179

Interior Astragal Cover, greater than 6-8

W9608

CN height	Length	Finish and Part Number			
		Bare Wood	White	Designer Black	Clear
7-0	82 19/32" (2098)	31506270	39206270	39209270	31606270
8-0	92 3/32" (2339)	31506280	39206280	39209280	31606280

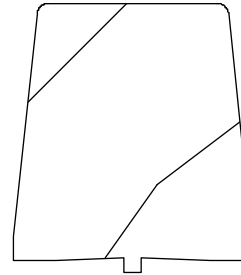

Suggested Fasteners	PN
2 - #8 x 2" Phillips flat head screws	11800868

Interior Astragal Base

W9609

CN height	Length	Finish and Part Number			
		Bare Wood	White	Designer Black	Clear
6-5	76 3/32" (1933)	31506165	39206165	39209165	31606165
6-8	78 19/32" (1996)	31506168	39206168	39209168	31606168
7-0	82 19/32" (2098)	31506170	39206170	39209170	31606170
8-0	92 3/32" (2339)	31506181	39206181	39209171	31606181

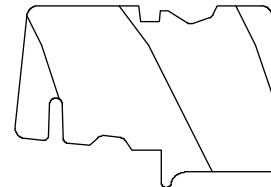

Suggested Fasteners	PN
2 - #8 x 2" Phillips flat head screws	11800868

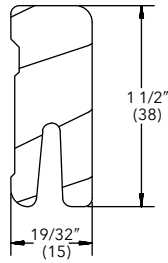

Sill Liner

No longer available. Replace with V2935

Frame Weather Strip

V2793

Head Jamb				
CN Width	Length	Black PN	Beige PN	
2-6	28 15/16" (735)	15557726	Replace with Black	
2-8	30 15/16" (786)	15557728		
3-0	34 15/16" (887)	15557730		
5-0	57 5/8" (1464)	15557750		
5-4	61 5/8" (1565)	15557754		
6-0	69 5/8" (1768)	15557760		
Jamb				
CN Height	Length	Black PN		Replace with Black
6-5	76 15/32" (1942)	15557765		
6-8	78 31/32" (2006)	15557768		
7-0	82 31/32" (2107)	15557770		
8-0	92 15/32" (2349)	15557780	Replace with Black	
Head Jamb/Jamb				
Size	Length	Black PN		
Lineal	150" (3810)	15557799		

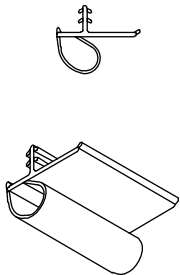

Astragal Weather Strip

V1560

CN Height	Length	Black PN	Beige PN
6-5	77 5/16" (1964)	15980765	Replace with Black
6-8	79 13/16" (2027)	15980768	
7-0	83 13/16" (2129)	15980770	
8-0	93 5/16" (2370)	15980780	

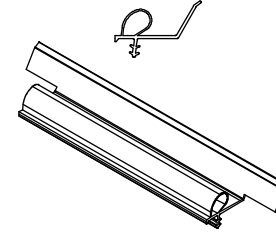

Sill Weather Strip

V2816

CN Width	Length	Black PN	Beige PN
2-6	28 21/32" (728)	15973626	15973226
2-8	30 21/32" (778)	15973628	15973228
3-0	34 21/32" (880)	15973630	15973230
5-0	57 11/32" (1456)	15973650	15973250
5-4	61 11/32" (1558)	15973654	15973254
6-0	69 11/32" (1761)	15973660	15973260

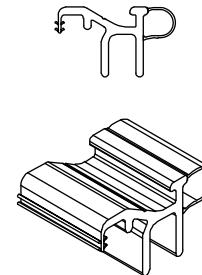

Exterior Astragal Weather Strip

V2800

CN Height	Length	Black PN
6-5	77 23/32" (1974)	15972865
6-8	80 7/32" (2038)	15972868
7-0	84 7/32" (2139)	15972870
8-0	93 23/32" (2380)	15972880

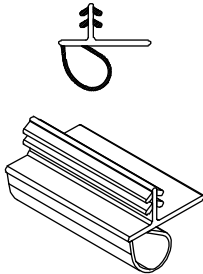

Panel Locking Stile Weather Strip

V1556

CN Height	Length	Black PN	*Beige PN
6-5	76 23/32" (1949)	15970365	15972765
6-8	79 7/32" (2012)	15970368	15972768
7-0	83 7/32" (2114)	15970370	15972770
8-0	92 23/32" (2355)	15970380	15972780

NOTE: *DISC (LA) used prior to 06/27/2017

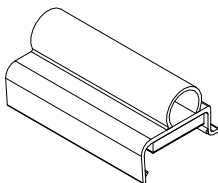

Panel Weather Strip Kit

V1550

NOTE: Includes weather strip between hinges and at panel ends.

Panel Stile			
CN Height	Length	Black PN	*Beige PN
6-5	Actual lengths will vary	11897051	11896684
6-8		11897053	11896685
7-0		11897055	11898870
8-0		11897057	11896686
Panel Top Rail			
CN Width	Length	Black PN	*Beige PN
2-6	28 19/32" (726)	25972650	15970226
2-8	30 19/32" (777)	25972654	15970228
3-0	34 19/32" (879)	25972660	15970230

NOTE: *DISC (LA) used prior to 06/27/2017

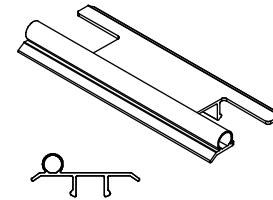

Dust Block

Color	PN
Gray	15600010

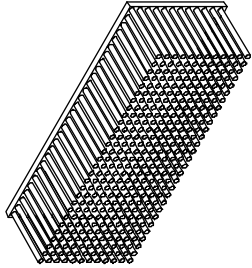

Jamb/Sill Foam Block

Color	PN
Beige	10500782

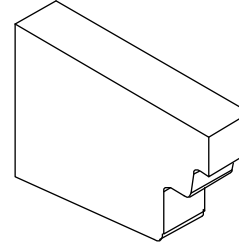

Jamb Weather Strip Plug

Color	PN
Beige	10500154

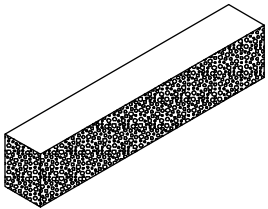

Frame Sealant, Foam, Sill Liner

1/16" x 3/8"
Adhesive backed

Length	Color	PN
Specify LF	Gray	10500142

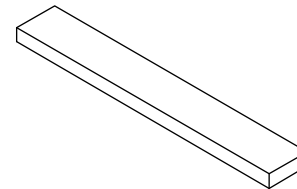

Exterior Astragal Weather Strip

V019

Usage dates:

For units produced until 06/26/2017

CN Height	Length	PN
6-5	77 23/32" (1974)	15971565
6-8	80 7/32" (2038)	15971568
7-0	84 7/32" (2139)	15971570
8-0	93 23/32" (2380)	15971580

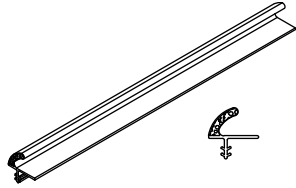

Ordering specifications (use all that apply):

1. Original order number/line number (if available)
2. Size
3. Operator or stationary
4. Handing
5. Exterior color
6. Interior finish
7. Glazing

NOTE: Operating panels include lock, sweep w/gasket, wood backers, weather strip, shoot bolt guides and astragal. Stationary panels include sweep w/gasket, stationary bracket, stile weather strip and eurogroove block.

Elevate Outswing French Door Manufactured 2007 to present	
Daylight Opening to Panel OM	
Daylight Opening Width + 7 1/4" = OM Width of Panel	
Daylight Opening Height + 9 5/8" = OM Height of Panel	
Width	
CN Size	OM Width
2-6	28 19/32" (726)
2-8	30 19/32" (778)
3-0	34 18/32" (879)
5-0	28 19/32" (726)
5-4	30 19/32" (778)
6-0	34 18/32" (879)
Height	
CN Size	OM Height
6-5	76 23/32" (1949)
6-8	79 7/32" (2012)
7-0	83 7/32" (2114)
8-0	92 23/32" (2355)

