

Contemporary Handle Installation Instructions

ABSTRACT: This instruction is intended for the following products produced 2014 to present:

- 1 3/4" Swinging Door
- 2 1/4" Swinging Door

Trimming the Tail Piece

1. Before installing the lock cylinder you will need to trim the tail piece to the appropriate length. Refer to [Figure 1](#) for the correct location based on your door configuration.

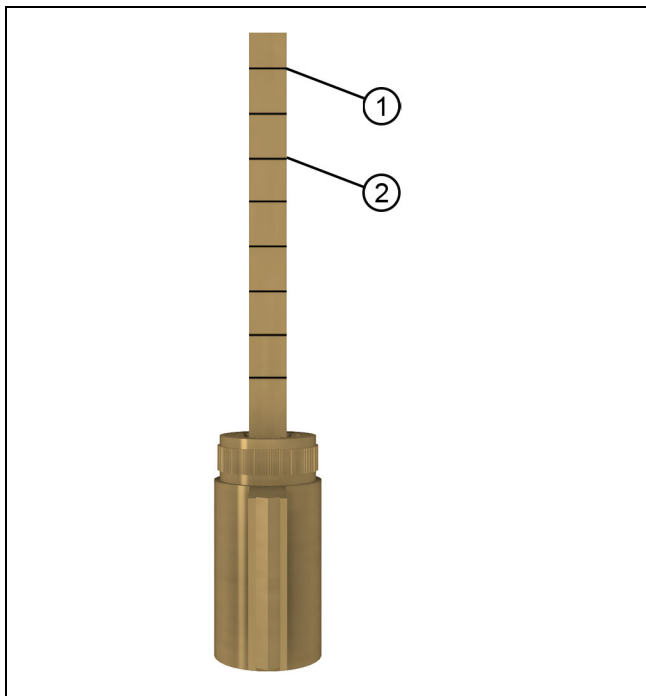

Figure 1

1	2 1/4" panel thickness, Contemporary Handle
2	1 3/4" panel thickness, Contemporary Handle

2. Use a pliers or similar tool to break the tail piece off.

NOTE: Alternatively, you can use a hack saw or rotary cut off tool.

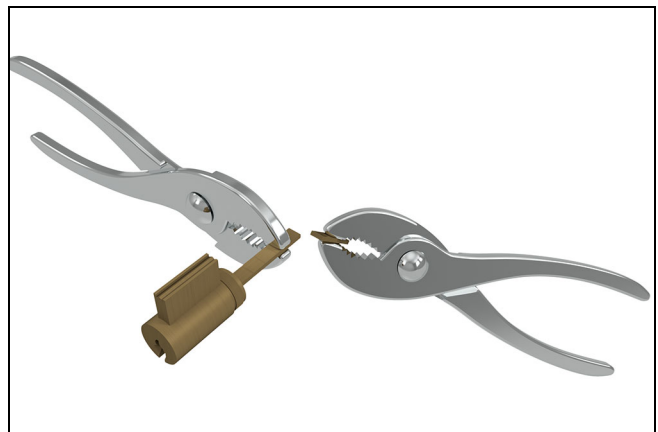

Figure 2

Installing the Handleset

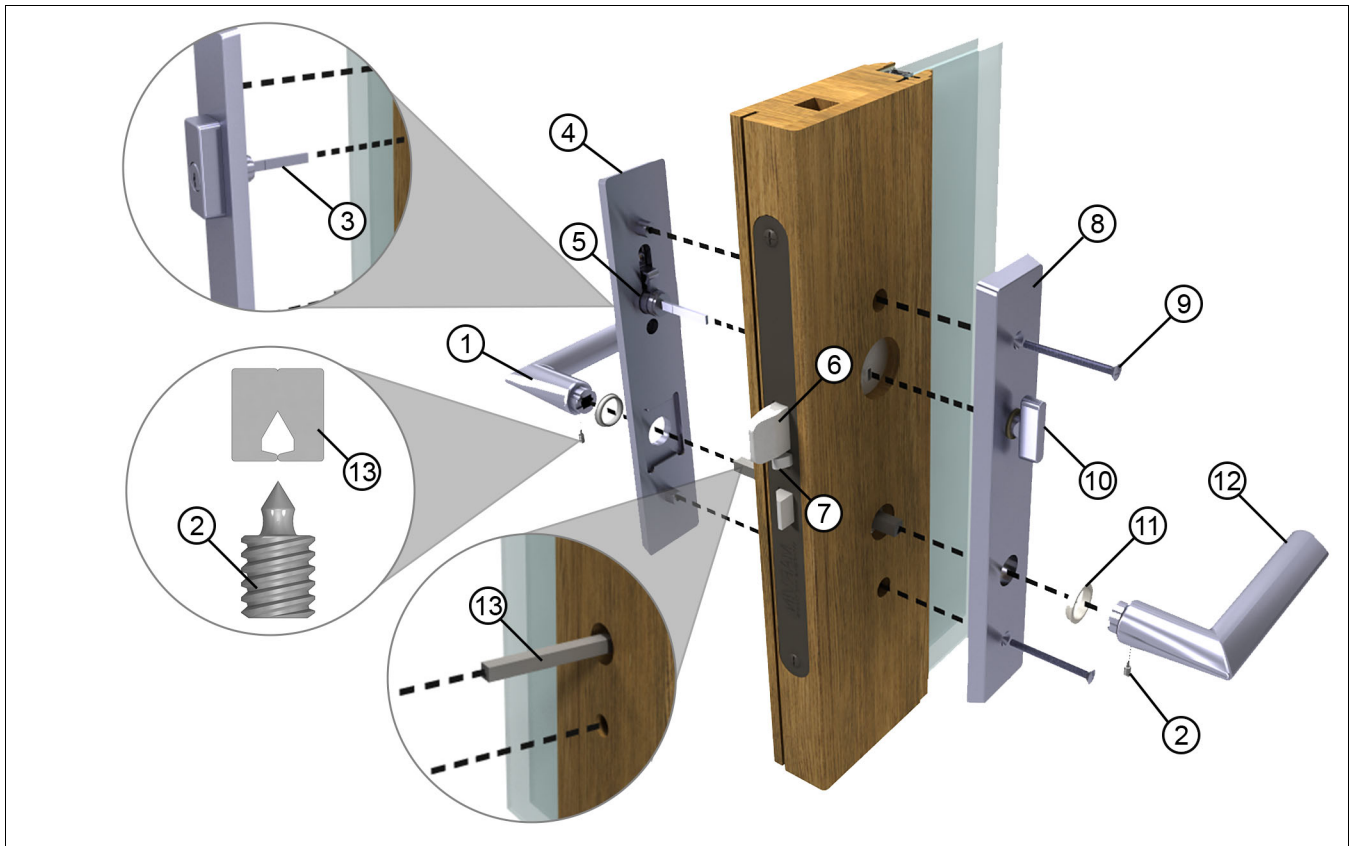

Figure 3

1	Exterior handle
2	Set screw (one for each handle)
3	Tailpiece
4	Exterior escutcheon
5	Lock cylinder
6	Deadbolt
7	Safety button
8	Interior escutcheon
9	Mounting screw (2)
10	Thumb turn
11	Nylon lever bushing (2)
12	Interior handle
13	Spindle (note the orientation so set screw will engage)

1. Slide the lock cylinder pin through the actuator slot in the vertical position.

2. Use the mounting screws to loosely fasten the interior and exterior escutcheons together. Press the safety button and rotate the key cylinder to actuate the deadbolt. Tighten the top mounting screw. Do not over-tighten as damage can result to the escutcheon plate.

NOTE: If key cylinder on handle does not actuate the deadbolt properly, DO NOT force the lock. Recheck the lock cylinder pin orientation. Remember to view rotation from the exterior (as the key would rotate).

3. Position the two spindle half relative to the handle set screw. Insert nylon lever bushing and spindle into the exterior handle and tighten the set screw. Now place spindle through the hole in the door stile, making sure the handle stays in the horizontal position.

NOTE: Tighten the set screw with the small end of the hex wrench until it begins to bend (about 30 in lbs).

4. Install the nylon lever bushing and interior handle onto the spindle and push handles together to slightly sandwich escutcheons onto the door. Secure the interior handle on the spindle and tighten the set screw provided. Operate the multi point by rotating the handles up and down. The safety button needs to be pressed during handle rotation. When the handle operates smoothly, tighten the bottom mounting screw.

NOTE: Check the spring assist in handle to assure that the handle returns to the correct location when activated.