













- On operator units, countersink and pre-drill holes 4" from each corner and one in the center of head jamb using a 1/8"(3) drill bit. Place holes on the groove used to hold in the parting stop. On picture units, use the holes already predrilled in the head jamb (done at the factory). Fasten the two units together with #7 x 7/8" Phillips flat head wood screws as shown in illustration 3.

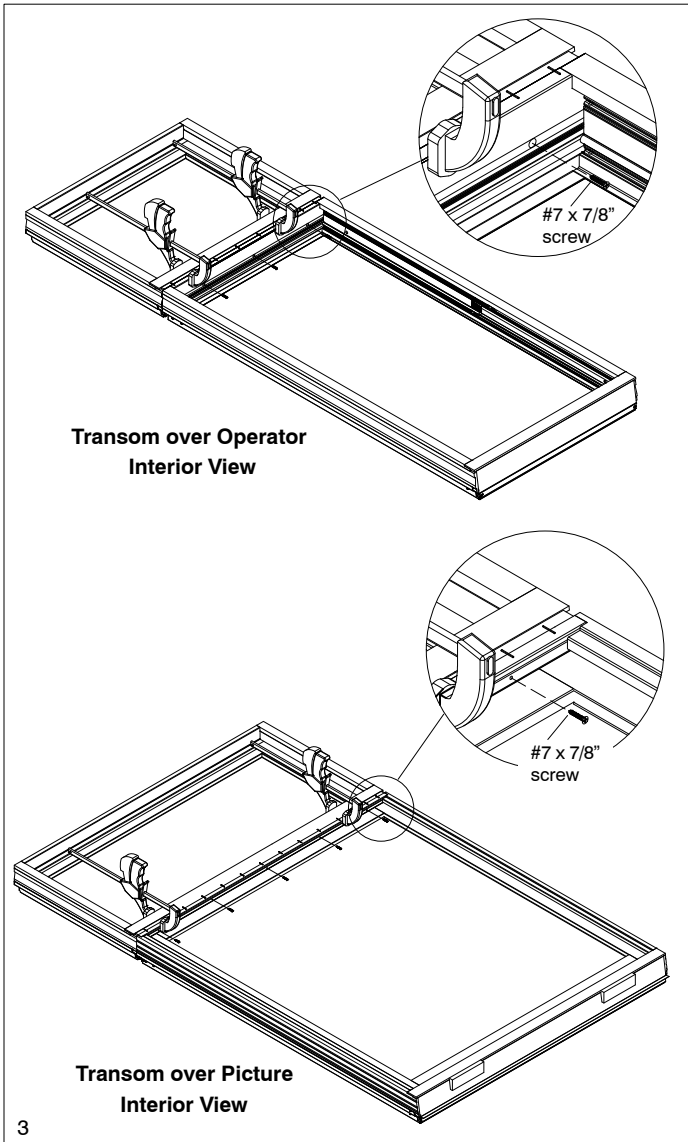

- Carefully turn assembly over (exterior side up). Apply frame kerf foam weather strip to the horizontal accessory kerf at mullion on both windows with a screen spline roller or similar tool. weather strip should run just up to the vertical accessory kerf. See illustration 4.

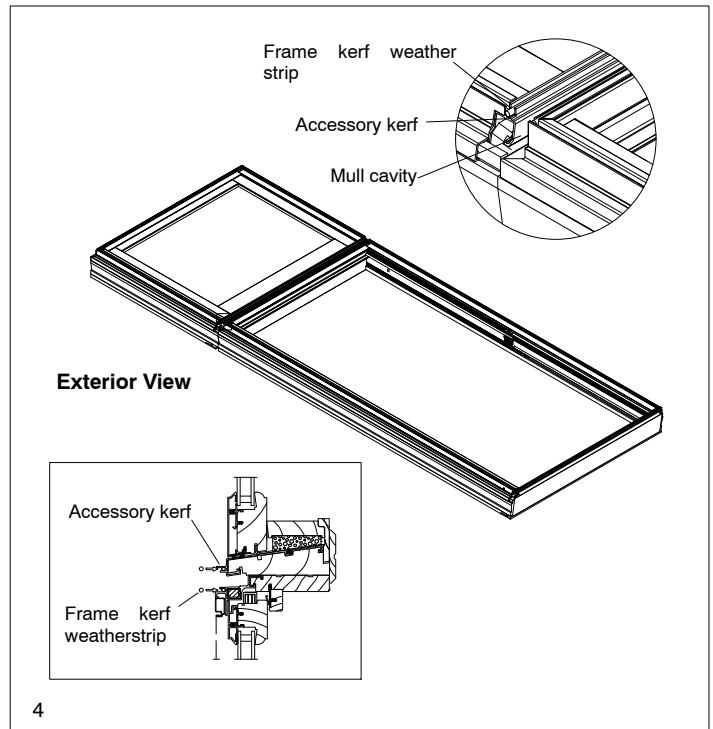

- Measure the width of mull from interior edge of accessory kerf from jamb to jamb as shown in illustration 5. Transfer measurement to the aluminum mull cap and cut with a power miter saw or hacksaw.

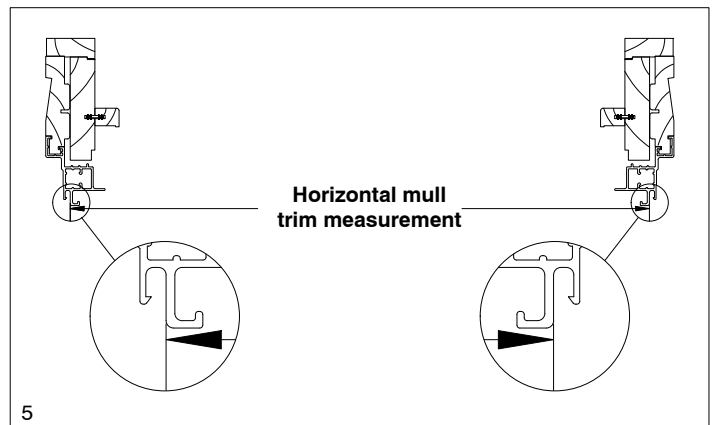

6. Cut the horizontal mull foam filler to the width of mull and place in mull cavity. Foam filler should extend the full width of the sill. See illustration 6.

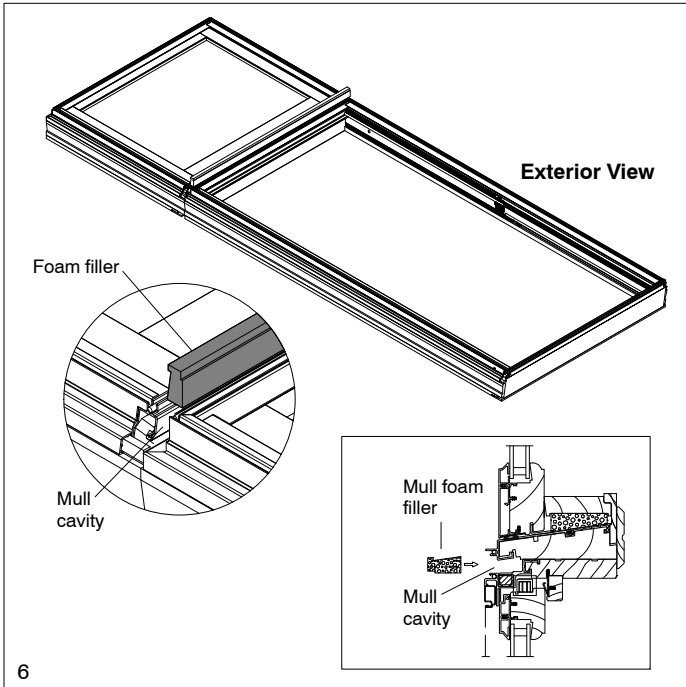

7. Apply a bead of sealant along both sides of foam filler. Sealant should run the entire length of the mull from jamb to jamb. Using a wood block and hammer, carefully pound mull cap into place making sure that it does not extend into the vertical accessory kerf. See illustration 7.

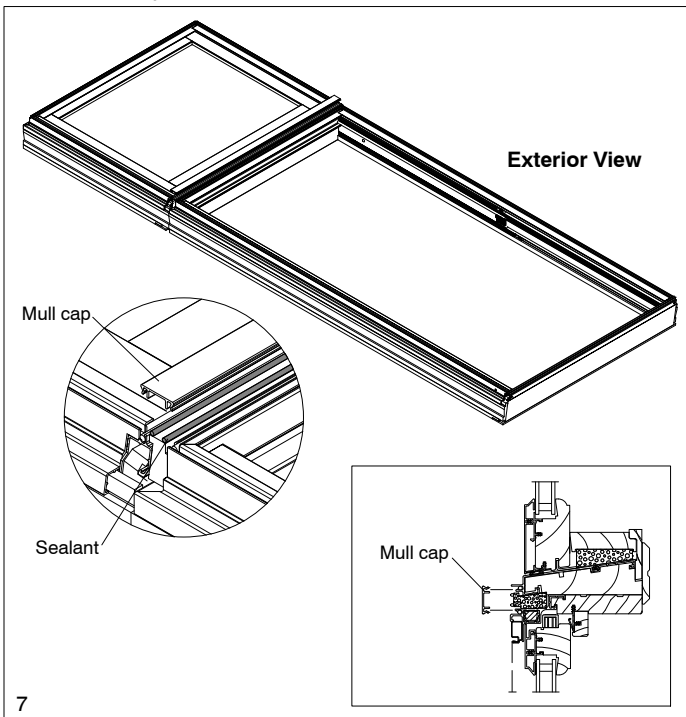

8. On operator units, replace the head jamb parting stop removed earlier.
9. Install mull insert windows following supplied installation instructions. Interior mull trim should be applied after unit is completely installed and interior trim is applied.